

# FASHION BATEN LED LUMINAIRES SPECIFICATION



## Fashion • Easy



- ✓ ETL And DLC Approved Size: 2FT 20W And 4FT 40W.
- ✓ Other Size Is available , 3FT, 5FT, 6FT , Max Length Is 8FT
- ✓ Two Version Design: Linkable Version and Independent Version
- ✓ Two Different Installation: Ceiling Mount And Hanging
- ✓ 5 Years Warranty



### Application:

- \* Cabinet ,Store,
- \* Dust-free Workshops
- \* Cleanroom

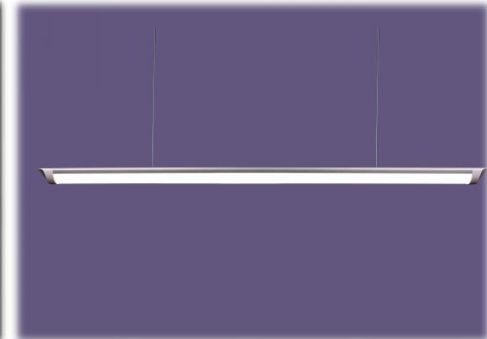

## Parameters:

Model	Wattage	Size	Input Voltage	Certification	Operation Condition	IP Grade	Max Connection (@120Vac)	Max Connection (@220Vac)
MC-BA-01-20X	20W	2FT/600mm	100-277Vac, 50/60HZ	ETL,DLC	-20℃~40℃	IP20	14PCS	25PCS
MC-BA-01-40X	40W	4FT/1200mm	100-277Vac, 50/60HZ	ETL,DLC	-20℃~40℃	IP20	6PCS	12PCS
MC-BA-01-30X	30W	3FT/900mm	100-277Vac, 50/60HZ	CE,ROHS	-20℃~40℃	IP20	8PCS	16PCS

Photometric	
LED	LM-80 SMD
Luminance	>110LPW
CRI	82Ra
R9	6
CCT	3700K-6500K
Beam angle	110°

**DLC CCT range:3500K-5000K**

Basic Specification	
Driver	Built-in
PF	0.9
Body Material	Aluminum(silver/white)
Life Span	50000Hrs
Warranty	DLC:5years
	ETL/CE:3years

## Dimension : mm

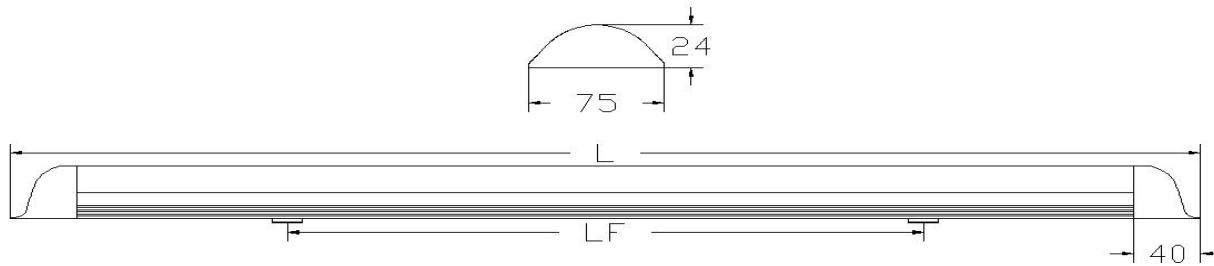

L=2FT=600mm  
L=3FT=900mm  
L=4FT=1200mm  
L=5FT=1500mm  
L=6FT=1800mm

## Accessories:

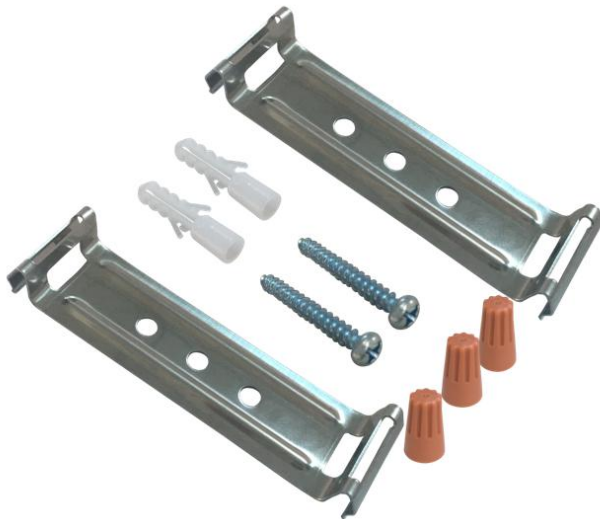

Stronger Metal clips and screw sets



Hanging sets(Optional )



## Linkable Version(Optional):

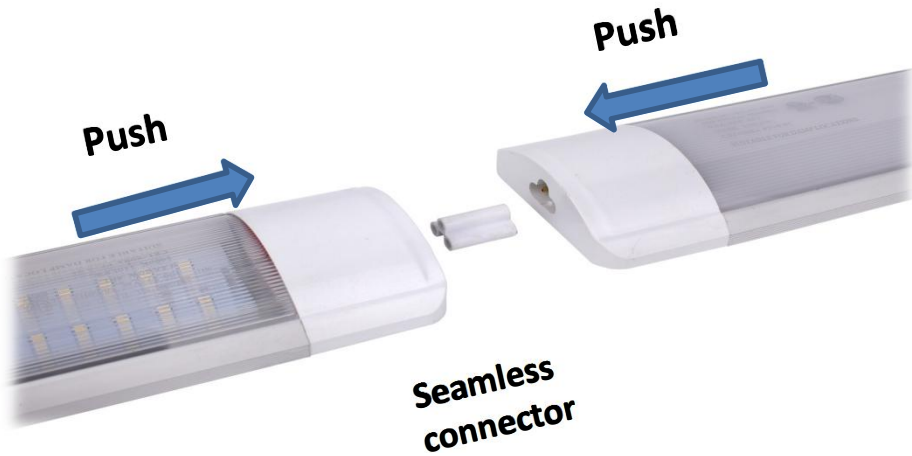

## Linkable Version Accessories:



## !WARNING!

**WARNING:RISK OF ELECTRICAL SHOCK.TURN OFF POWER BEFORE INSTALLING,REMOVING OR INSPECTING.**

**WARNING:ALL WIRING TO BE PERFORMED IN ACCORDANCE WITH ELECTRICAL CODE AND LOCAL ELECTRICAL CODE**

**WARNING:RISK OF FIRE.FIXTURES ARE RATED FOR USE IN 100-277Vac,50-60HZ PROTECTED CIRCUIT AND 90°C RATED SUPPLY WIRE.**

**WARNING:RISK OF CUT.THE ENCLOSED PRODUCT MAY HAVE SHARP EDGES,WEAR GLOVES TO PREVENT CUTS WHEN HANDING,REMOVING,INSTALLING AND MAINTAINING THIS PRODUCT.**

### Suspension Installation Guide:

Step 1:Identify the rope two terminals

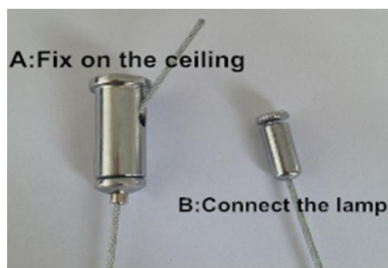

Step 2:Loosen A terminals



Step 3:Fix the screw on the ceiling wall for pendant rope.

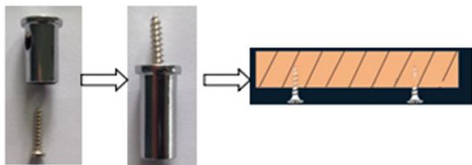

Step 4:Loosen B terminal ,connect the clamp and rope together

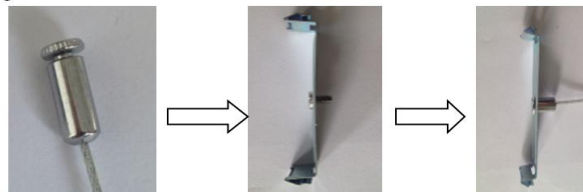

Step 4:clip the lamp and clamp together.Same step for other clamp



Step 4:Adjust the rope length.Then finish installation.

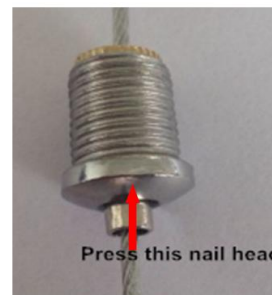

## Ceiling Installation Guide:

Step 1:Corresponding Installation Position,Set a Suitable Clamp Position.

Step 2:Pushing holes for screw at the surface of the installation platform,install the screw and suspension parts,use the screw to fix the suspension part.

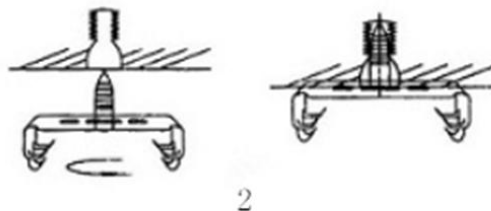

Step 3:Lock the one side of lamp body to the fixture,then other side.

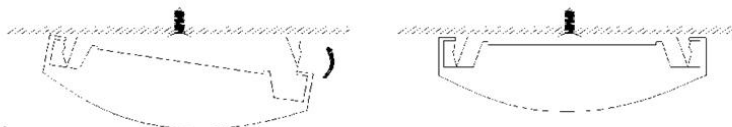

Step 4:Check the lamp is located firmly.

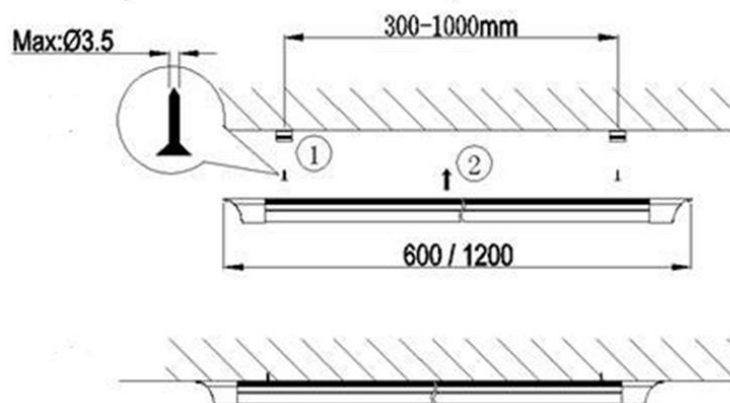





### MC-BA-01-20X

1Set/inner Carton  
 20sets/Carton  
 12KG/Catron  
 0.052CBM/Carton

### MC-BA-01-40X

1Set/inner Carton  
 10sets/Carton  
 11KG/Catron  
 0.05CBM/Carton



\*1set include these accessories:  
 2PCS ceiling mounting metal clips;  
 1PCS input cable;  
 screws



Container	QUANTITY			
20'	20W	360-390CTNS	7200PCS-7800PCS	
	40W	400-409CTNS	4000PCS-4090PCS	
40'	20W	720-780CTNS	14400PCS-15600PCS	
	40W	800-816CTNS	8000PCS-8160PCS	

\*Other size Package pls contact us